

# Active Parallel Gripper

## Getting Started Guide

Active Parallel Gripper

# Box Contents

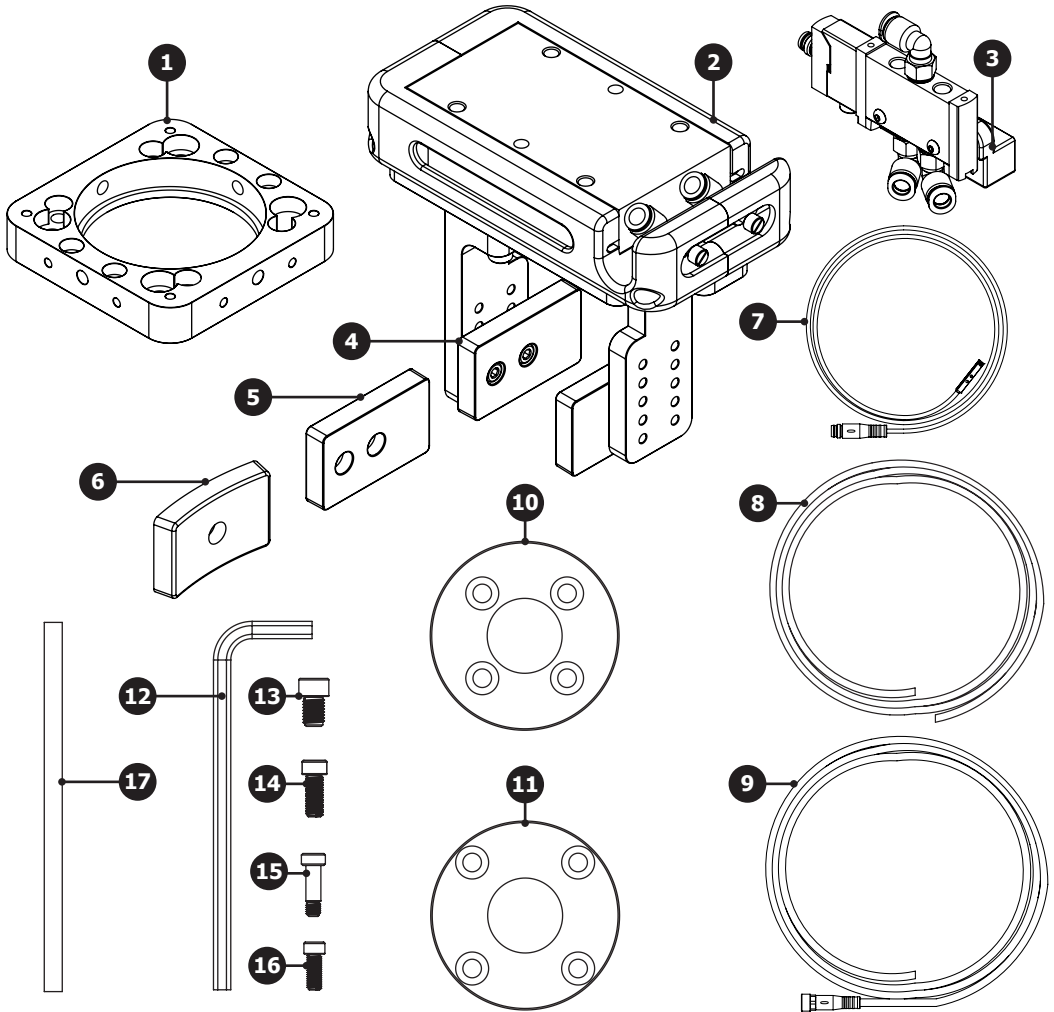

**1.** Universal Tool Plate

**2.** Parallel Gripper Tool

**3.** Solenoid & Mounting Bracket

**4.** 2x NBR Gripper Pads (Black)

**5.** 2x Silicone Gripper Pads (Grey)

**6.** 2x NBR Curved Gripper Pads (Black)

**7.** 2x Position Sensors & Cable

**8.** Solenoid Pneumatic Tubing (3000 mm)

**9.** 3x Solenoid Cable & Sensor Cable

**10.** ISO 40 Mounting Plate

**11.** ISO 50 Mounting Plate

**12.** 5x Allen Keys Included

**13.** 4x M6 Bolts

**14.** 4x M5 Bolts

**15.** 4x Shoulder Bolts

**16.** 2x M4 Fixing Bolts

**17.** 2x Pneumatic Tubes (100 mm)

## Step 1 Mounting Plate Assembly

1. Select your mounting plate and fix to the robot using M6 bolts provided.

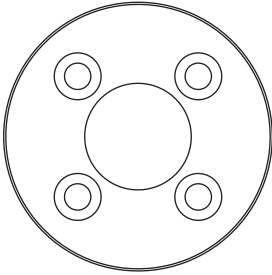

### ISO 40 Mounting Plate

Suitable for Rethink Robotics' Sawyer, ABB Robots using ISO 9409-1-40-4-M6 compatible mounting plate.

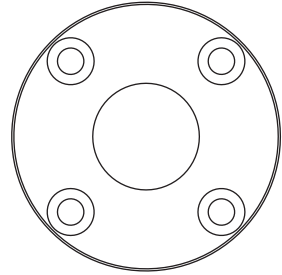

### ISO 50 Mounting Plate

Kuka iiwa, Universal Robots UR3, UR5 and UR10 using ISO 9409-1-50-4-M6 compatible mounting plate.

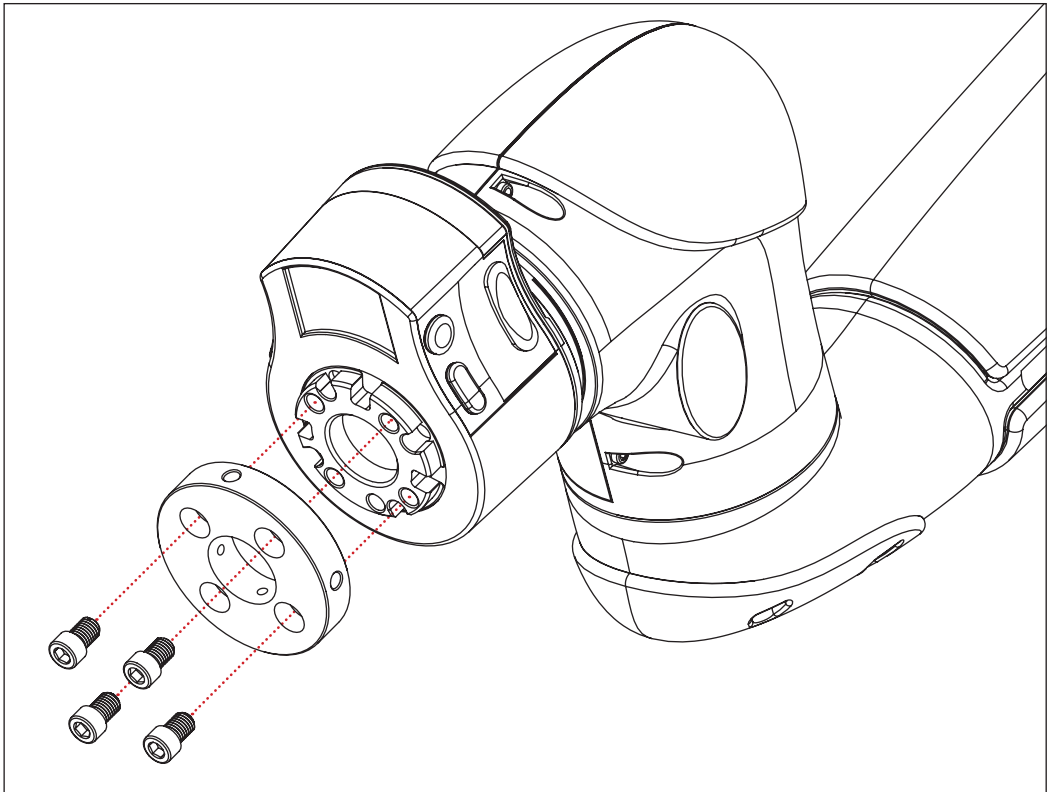

## Step 2 Install Universal Tool Plate

2. Install the universal plate to the parallel gripper using 4x M5 fixing bolts.

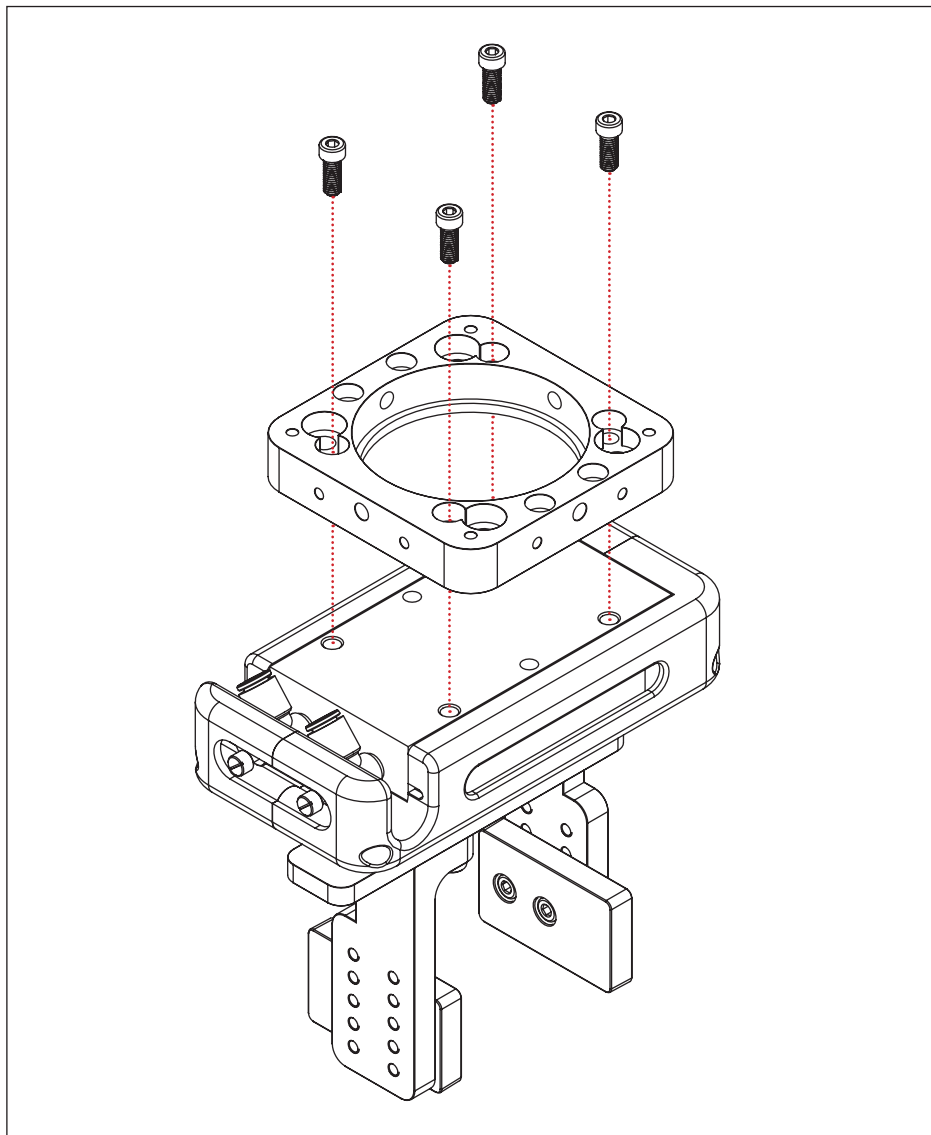

## Step 3 Install the Parallel Gripper

3. Install the parallel gripper on the robot using 4x shoulder bolts.



**Fit all 4x shoulder bolts loosely to align the holes before final tightening.**

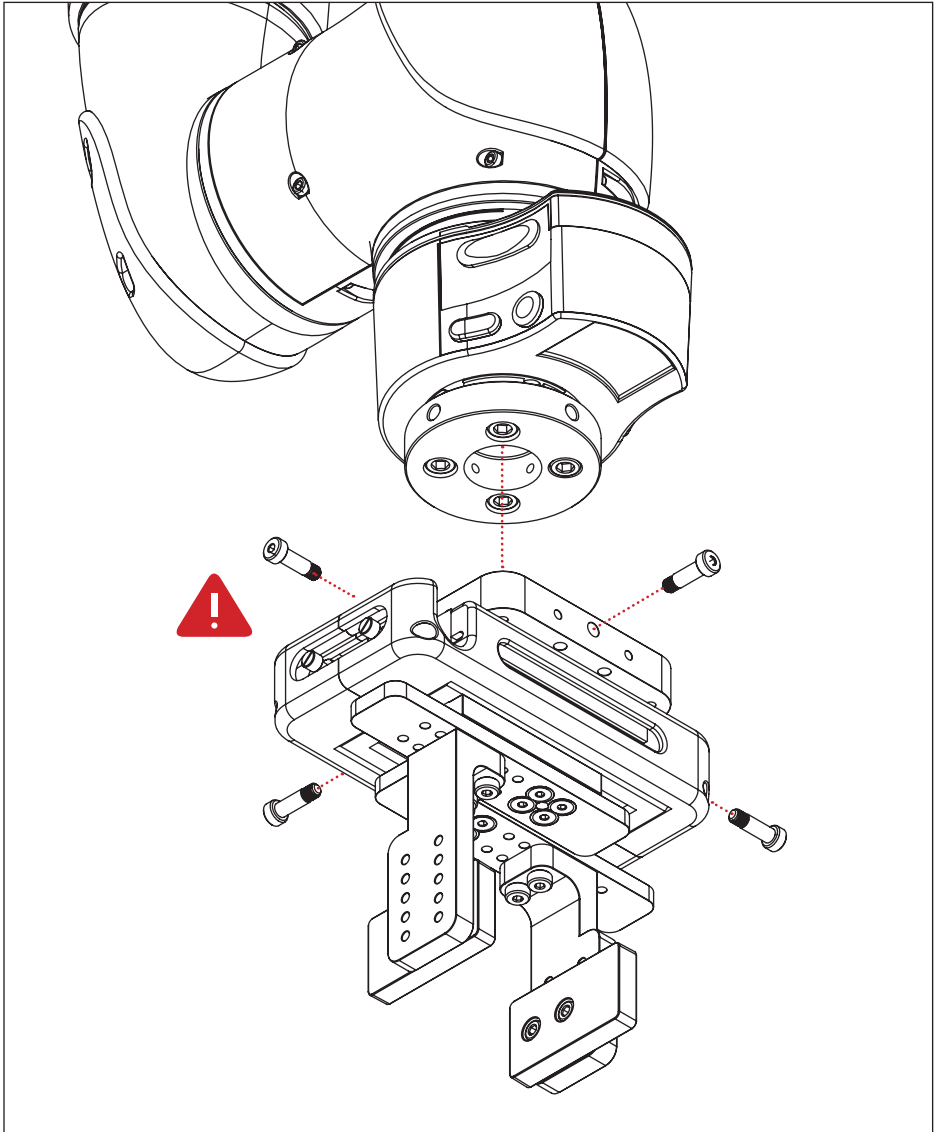

## Step 4 Install the Solenoid Cable

4. Install the solenoid using 2x M4 fixing bolts and then assemble the piping.
5. Reverse connections to change the default state, normally open, normally closed.
6. Adjust the speed controllers to vary open and close speeds.
7. Adjust the position sensors to suit the jaw travel.
8. Adjust air supply pressure to tune grip force.

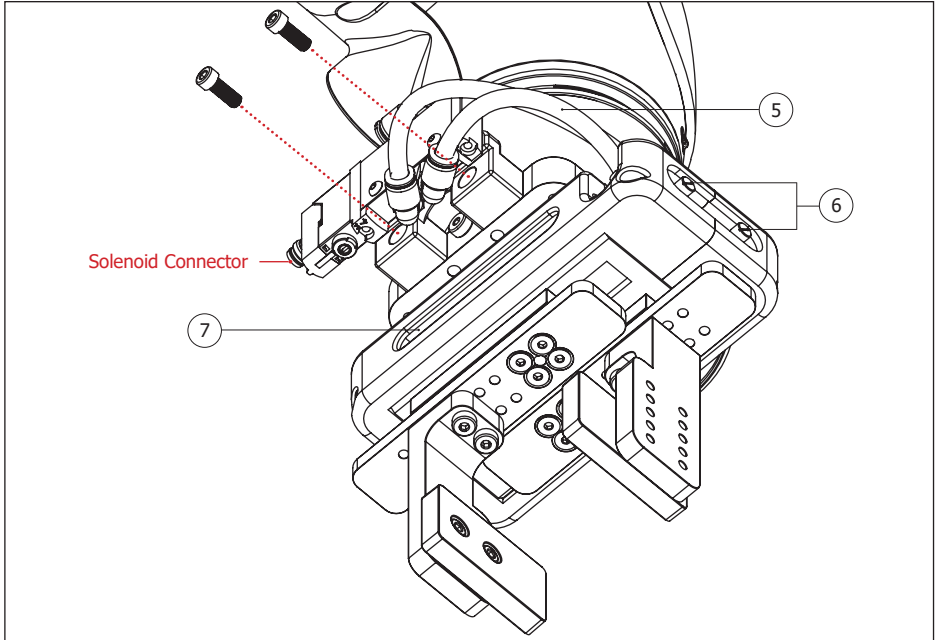

### Solenoid Cable Specification



### Sensor Cable Specification

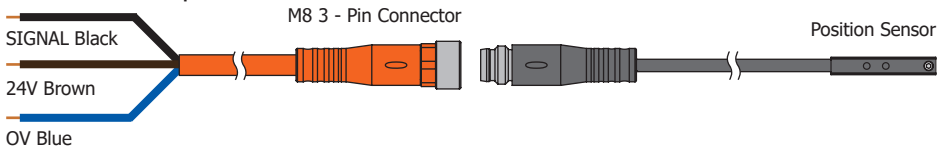

# Configurations

## 9. Alternative gripper options:

### External Parallel Grip

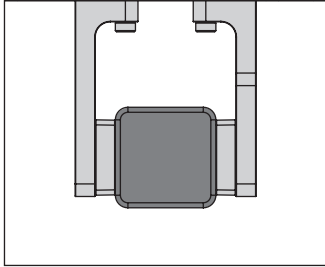

### Internal Parallel Grip

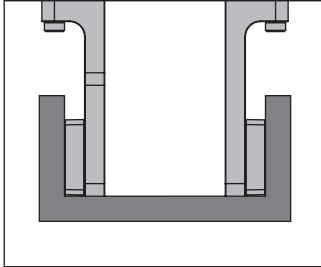

### Curved Grip

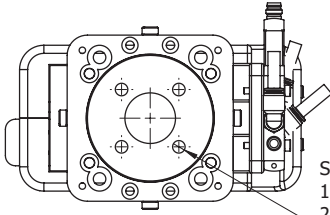
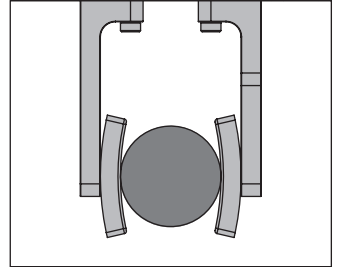

#### SUPPORTED ROBOT BOLT PATTERNS

1. ISO 9409-1-40-4-M6 (40MM PCD WITH 4XM6 THREADS)
2. ISO 9409-1-50-4-M6 (50MM PCD WITH 4XM6 THREADS)

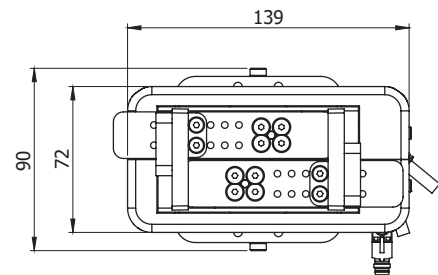
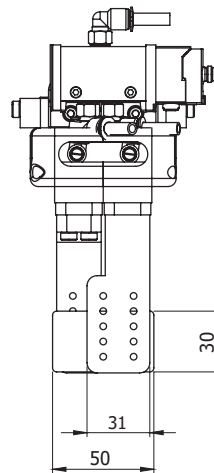
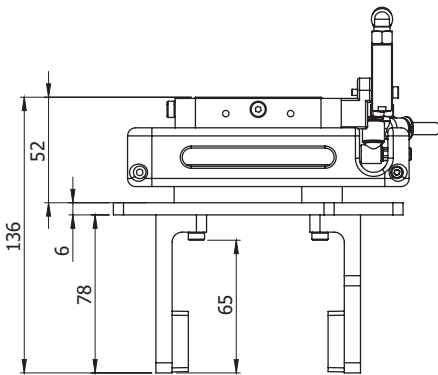

### Gripper Specification

- Grip range:** 0 to 175mm
- Stroke:** 2x20mm
- Max freq:** 2Hz
- Closing time no load:** 0.1s
- Grip force per jaw:** 100N @ 6 Bar
- Tool Weight:** 980g

Thank you for choosing the Active Parallel Gripper.

This supplement provides you with information relating to the Active Parallel Gripper and is correct at the time of publishing.

**[www.active8robots.com](http://www.active8robots.com)**

**Active8 Robots (Active Robots Ltd)**

Unit 10A New Rock Industrial Estate,

Chilcompton

Radstock

Somerset

BA3 4JE

United Kingdom

+44 (0)1761 239 267



Registered: England & Wales

Company number: 4693628

VAT Reg: GB 810 7979 13

