

Beam Couplings

CL1 Miniature Series

- One-piece metallic beam coupling
- Zero backlash, flexible shaft
- Spiral and parallel cut designs available
- Accommodates misalignment and shaft endplay
- Identical clockwise and counterclockwise rotational characteristics
- Available in aluminum or stainless steel
- Multiple bore and shaft connecting configurations



Aluminum



Stainless Steel

CL1 OPTIONS

- Aluminum Alloy
- Stainless Steel
- Spiral
- Parallel
- Setscrew

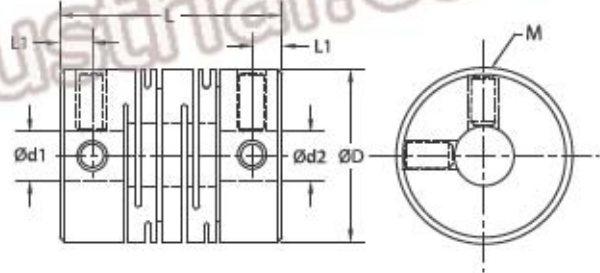
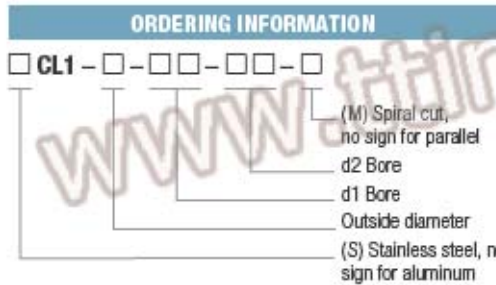

Parallel shown; spiral and parallel dimensions are identical.

CL1 PARALLEL AND SPIRAL DIMENSIONS

Model	Bore Range (Ød1-Ød2)		ØD	L	L1	M	Wrench Torque					
	Parallel and Spiral Models											
	in	mm						mm	mm	mm	metric	Nm
CL1-M15 SCL1-M15	0.12-0.20	3-5	15.5	21	2.6	M3	0.7					
CL1-15 SCL1-15	0.12-0.20	3-5	15.5	23	3.1	M3	0.7					
CL1-17 SCL1-17	0.16-0.24	4-6	17.5	23	3.1	M3	0.7					
CL1-19 SCL1-19	0.20-0.31	5-8	19.5	24.5	3.5	M4	1.5					

CL1 PARALLEL AND SPIRAL SPECIFICATIONS

Model	Rated Torque		Max. Torque		Max. Speed	Moment of Inertia	Static Torsional Stiffness	Errors of Eccentricity (mm)		Errors of Shaft Angularity (°C)		Errors of Shaft Endplay (mm)	Mass (g)
	lb-in	Nm	lb-in	Nm				Parallel	Spiral	Parallel	Spiral		
CL1-M15	1.77	0.2	3.54	0.4	13000	3.0×10^{-7}	35	0.1	0.12	1.5	2	± 0.15	10
CL1-15	1.77	0.2	3.54	0.4	13000	3.2×10^{-7}	36	0.1	0.12	1.5	2	± 0.15	10
CL1-17	2.65	0.3	5.31	0.6	12000	6.1×10^{-7}	65	0.1	0.12	1.5	2	± 0.25	12
CL1-19	3.54	0.4	7.08	0.8	10000	8.5×10^{-7}	100	0.1	0.12	1.5	2	± 0.25	14
SCL1-M15	2.65	0.3	5.31	0.6	13000	8.7×10^{-7}	70	0.1	0.12	1.5	2	± 0.15	28
SCL1-15	2.65	0.3	5.31	0.6	13000	8.9×10^{-7}	72	0.1	0.12	1.5	2	± 0.15	30
SCL1-17	3.54	0.4	7.08	0.8	12000	1.5×10^{-6}	160	0.1	0.12	1.5	2	± 0.25	34
SCL1-19	7.96	0.9	15.93	1.8	10000	2.0×10^{-6}	205	0.1	0.12	1.5	2	± 0.25	40